

*Range*

—  
**DAWN**



—  
**PRICELIST**  
PRESS

—  
**EXPORT**  
01.07.2022



## Range

# DAWN

DAWN is a series of elegant veneered storage furniture with solid wood crafted handles. With this range you can create an underestimated but warm and welcoming atmosphere in your home.

### Designed by

Cecilie Kamp

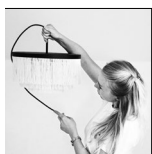

### This range include

Sideboards  
Vitrines  
HIFI-sideboards

## Social media

Follow and share with us on Instagram.

 @kristensenfurniture | #kristensenfurniture

## Features



### Design elements

Choose from different designs and add ons.



### Custommade

In addition to our many standard options we can accommodate special requests.



### Wood colours

Choose between more than 10+ different wood colours in both ash and oak.



### Sustainable choice

Solid wood furniture can last a lifetime with proper maintenance

## Online Pricelist- and imagebank

On our sharefile you as a retailer always have access to the newest pricelists and hundreds of high resolution images and videos  
— **Free to use in your marketing!**

If you do not have an account yet, please contact us and then we will set it up for you!

# PRICELIST

Veneered storage furniture w/crafted handles

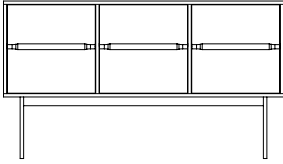
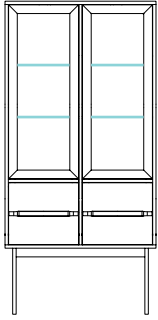
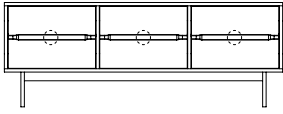

Description & drawing	Item no.	Size (cm)			Price (EUR)	
		B	D	H	ASH	OAK
 3 doors w/soft-close	BS3D-B160H90	160	38	90*		
 LED, 2 glass doors w/push, og 2 tredør m/soft-close	BV4D-B86H180	86	38	180**		
 3 doors w/soft-close, w/wire outlet in the back	BS3D-B160H60	160	38	60***		

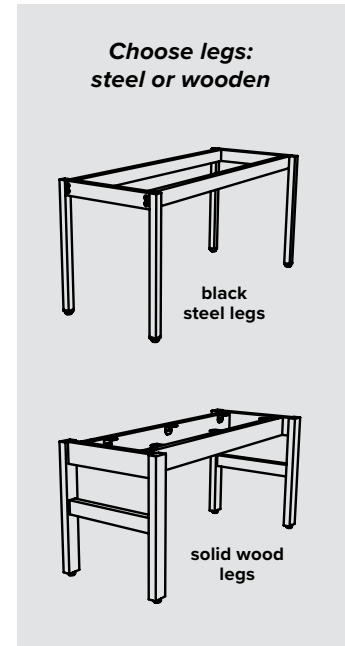

\*Leg height 34 cm \*\*Leg height 38 cm \*\*\*Leg height 20 cm

# INFO

## Inner room sizes and extra shelves

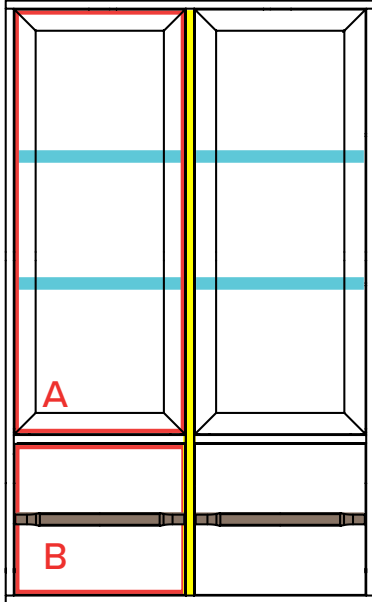

**BV4D-B86H180**  
with LED  
(H142 cm w/o legs)

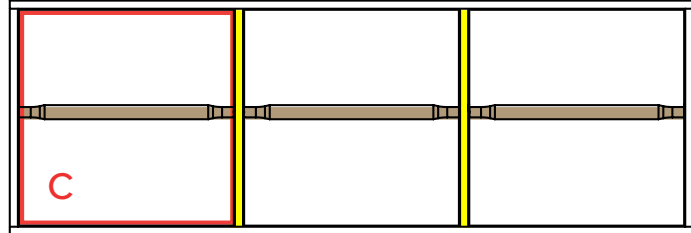

**BS3D-B160H90**  
(H56 cm w/o legs)

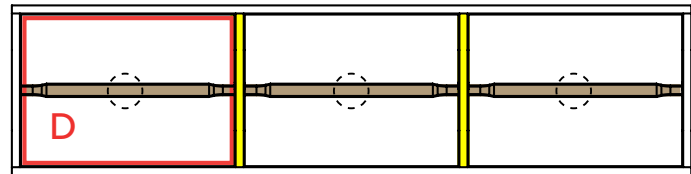

**BS3D-B160H60**  
(H40 cm w/o legs)



**Handles**  
—  
Solid wood

### Extra glass shelf

for vitrine:

 K-SHELF-GL-S3 (39,85 x 32 x 0,6 cm)

### Extra wooden shelf (veneered)

 for vitrine: K-SHELF-VEVI (39,85 x 32 x 1,6 cm)

 for sideboard: K-SHELF-VESB (50,50 x 33 x 1,6 cm)

 *Inner wall*

 *Wire outlet/hole in the back*

### Size of the inner rooms

**A**

Room behind the glass door:  
B40 x D33 x H100 cm

**B**

Room behind the door:  
B40 x D33 x H36 cm

**C**

Room behind the door:  
B51 x D33 x H52 cm

**D**

Room behind the door:  
B51 x D33 x H36 cm

**All shelves can be adjusted a little up/down.**

DAWN



**Images for guiding purpose only!**

The wood structure and colour will vary from ash and oak.

We therefore recommend using the wood samples/exhibition furniture to get a more accurate impression.

# WOOD COLOURS



**ASH C3 / OAK C3**  
Lacquered

We treated this wood with lacque.

*C3 are only made for products without patination.*



**ASH C4 / OAK C4**  
Natural oiled

We treated this wood with our 'Natural oil'.



**ASH C6 / OAK C6**  
White oiled

We treated this wood with our 'White oil'.



**ASH C8 / OAK C8**  
Soaped

We treated this wood with soap.



**ASH C11 / OAK C11**  
Dark grey oiled

We treated this wood with our 'Black oil'.



**ASH C12 / OAK C12**  
Antique brown oiled

We treated this wood with our 'Antique brown oil'.



**ASH C13 / OAK C13**  
Light grey oiled

We treated this wood with our 'Light grey oil'.



**ASH C14 / OAK C14**  
Black stained & oiled

We treated this wood with black stain, and treated it with a wax oil.

*C14 is for legs and storage furniture only!*



**ASH C15 / OAK C15**  
Mocca brown oiled

We treated this wood with our 'Mocca brown oil'.



**ASH C16**  
Warm white oiled

We treated this wood with our 'Warm white oil'.

*C16 is only for ash*



**ASH C20 / OAK C20**  
Grey brown oiled

We treated this wood with our 'Grey brown oil'.



**ASH C44 / OAK C44**  
Black matt lacquered

We treated this wood with black stain, and treated it with matt lacque.

*C44 is only for plates and can only be made for products without patination.*



For more information about maintenance, please visit our website:  
[WWW.KRISTENSEN.COM](http://WWW.KRISTENSEN.COM)



We also offers our own repairoils for our products  
- contact us if you need a pricelist.

# CONTACT

---

## CUSTOMISED TABLES

We are able to produce all our table types in special sizes. Furniture in special sizes requires special handling both in terms of manual handling, new drawings, machine settings and packaging. We therefore include a sur-charge for products in special sizes, whether the product will be larger or smaller. If you want a table in a smaller size e.g, the price is added 15% on the price of the nearest standard size.

*Contact us for more information!*

### Agent, Norway

Paal Stenvaag

—

✉ [post@mobelpaal.no](mailto:post@mobelpaal.no)

☎ +47 926 18 628

### Agent, Finland

Jokko Salmevaara

—

✉ [jokko.salmevaara@boknas.fi](mailto:jokko.salmevaara@boknas.fi)

☎ +358 401 958 886

### Agent, Sweden

Mikael Deragården

—

✉ [mikael@deragarden.com](mailto:mikael@deragarden.com)

☎ +46 0702 115 125

### Agent, UK

Brendan Brett

—

✉ [kristensen@theukagency.co.uk](mailto:kristensen@theukagency.co.uk)

☎ +44 77 34 265 599

### Head office, Denmark

**PHONE:**

+45 75470303

**WEBSITE:**

[www.kristensen.com](http://www.kristensen.com)

**MAIL:**

[kristensen@kristensen.dk](mailto:kristensen@kristensen.dk)

**ORDER MAIL:**

[order@kristensen.dk](mailto:order@kristensen.dk)

**CLAIMS:**

[claim@kristensen.dk](mailto:claim@kristensen.dk)

**FAX:**

+45 75470304

**ADDRESS:**

Kristensen & Kristensen A/S  
Storstrømsvej 44  
6715 Esbjerg N  
DK - Denmark

**TERMS & CONDITIONS**

—

Can be sent via email by request – contact:

[kristensen@kristensen.com](mailto:kristensen@kristensen.com)

